



Project Details

| | |
|----------|--|
| PROJECT | |
| DATE | |
| TYPE | |
| PREPARER | |



The Saturn LED Post Top light fixture offers a modern upgrade to standard outdoor lighting with top-tier performance and aesthetic appeal. It uses cutting-edge LED technology to ensure operation without maintenance and a marked decrease in power usage. The sleek, low-profile design is available in wattages from 30W to 150W and offers a range of color temperatures between 3000K and 5000K, adjustable via a dip switch. Ideal for illuminating expansive outdoor spaces, the Saturn is an excellent selection for parking lots, corporate parks, retail areas, walkways, and various municipal and general lighting needs.

SPECIFICATIONS

Product Features

Construction

- Die-Cast Aluminum housing
- Anti-static powder coating
- IP66 Rating
- Polycarbonate Lens
- Superior thermal management

Installation & Mounting

- Single Arm Mount
- Double Arm Mount

Controls & Dimming

- 0-10 Volt Dimming
- 12 Volt AUX
- Twist-lock Dusk to Dawn PC
- Bi-level Occupancy Sensor

PERFORMANCE

Summary

| | |
|--------------------|---|
| Input Voltage | 100-277V |
| Input Frequency | 50/60 Hz |
| Rated Wattage | 30W-50W-60W (<i>Selectable</i>) 60W-80W-100W (<i>Selectable</i>) 100W-120W- 150W (<i>Factory order</i>) |
| Efficacy | 130 lm/W |
| CRI | >80 |
| Available CCT | 3000K, 4000K, 5000K |
| Rated Life (L70) | 100,000 hrs |
| IP Rating | IP65 |
| PF | >0.9 |
| Certifications | UL, DLC, CE, RoHS |
| Working Temp. (°F) | -40°F - 122°F |
| LED Light Source | SMD 2835 |



LIGHT DISTRIBUTION

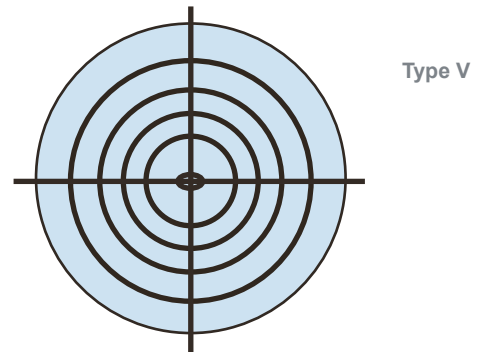
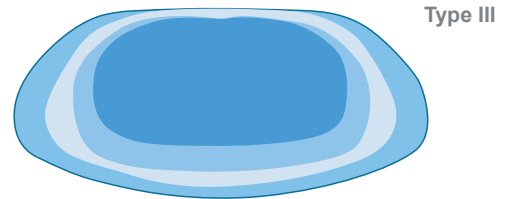
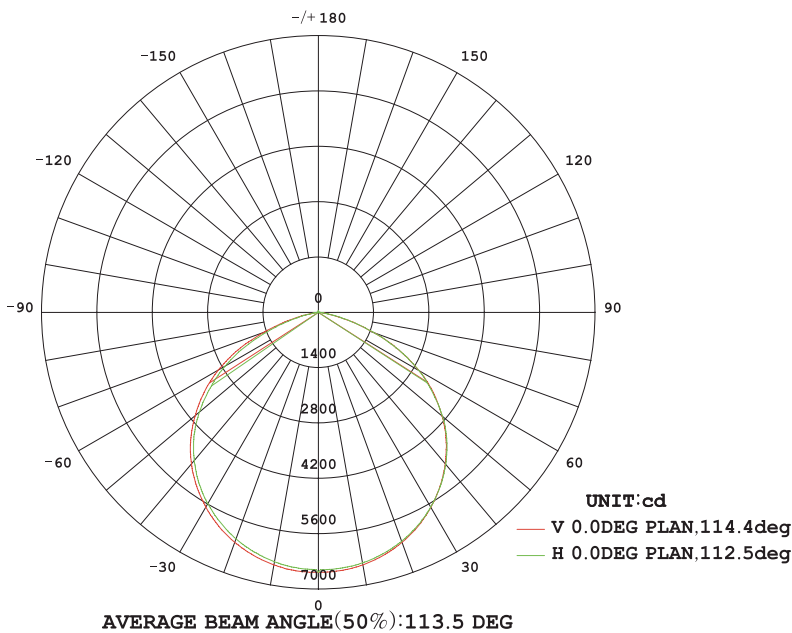

PERFORMANCE

Data

| MODEL | WATTAGE | LUMEN (CCT:3000) | LUMEN (CCT:4000) | LUMEN (CCT:5000) | EFFICACY (lm/W) | VOLTAGE |
|-------------|---------|---------------------|---------------------|---------------------|-----------------|------------|
| NB-SPT-30W | 30watt | 3810lm | 3,900lm | 3,960lm | 130 lm/W | 100-277vac |
| NB-SPT-50W | 50watt | 6,350lm | 6,500lm | 6,600lm | 130 lm/W | 100-277vac |
| NB-SPT-60W | 60watt | 7,620lm | 7,800lm | 7,920lm | 130 lm/W | 100-277vac |
| NB-SPT-80W | 80watt | 10,160lm | 10,400lm | 10,640lm | 130 lm/W | 100-277vac |
| NB-SPT-100W | 100watt | 12,900lm | 13,000lm | 13,400lm | 130 lm/W | 100-277vac |
| NB-SPT-120W | 120watt | 15,240lm | 15,600lm | 15,960lm | 130 lm/W | 100-277vac |
| NB-SPT-150W | 150watt | 19,200lm | 19,650lm | 20,100lm | 130 lm/W | 100-277vac |

ORDER

Data

Sample: **NB-SPT-60W-30-T5-SA1-MS**

| SERIES | WATTAGE | CCT | VOLTAGE | OPTICS | FINISH* |
|--------|-----------------|--|--------------|--------|--|
| NB-SPT | 30W-50W-60W | 30 = 3000K 40 = 4000K 50 = 5000K | V = 100-277V | T5 | BLANK = Bronze WH = White BLK = Black* |
| | 60W-80W-100W | | | | |
| | 100W-120W- 150W | | | | |

* Contact the Nebulite sales team for turnaround time and pricing on finish color customizations



Double Arm



Single Arm

MOUNTING

Options

| | | | |
|-----|-------------------------|-----|-------------------|
| SA1 | Single Arm 2 3/8" | DA1 | Double Arm 2 3/8" |
| SA2 | Double Arm 3" | DA2 | Double Arm 3" |
| PCN | JL-205C Photocell 3 PIN | MS | ANT-5-4T |

DIMENSIONS

30 Watt - 150 Watt
Housing Size (in)

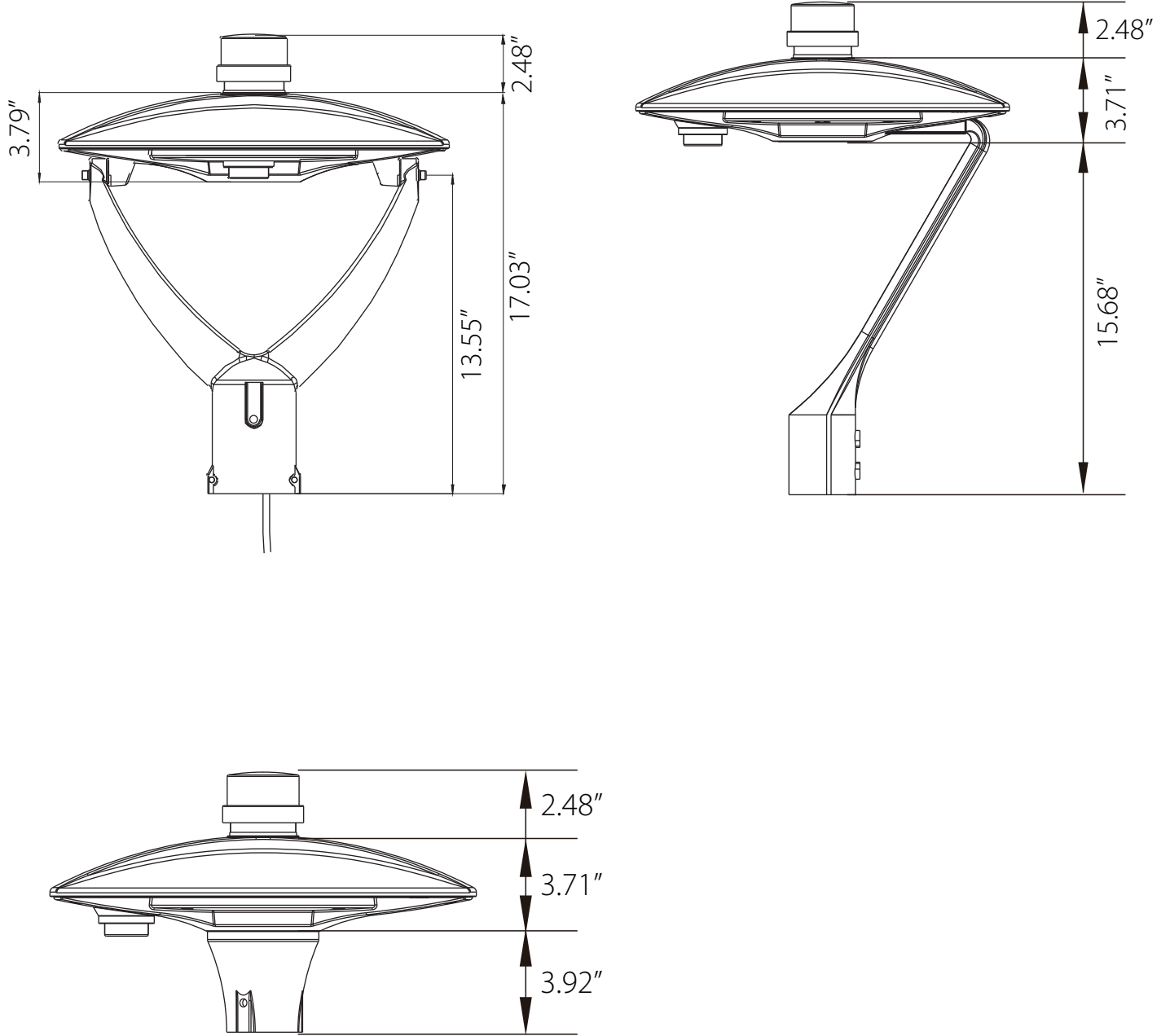



| | |
|--------------------------|--------------------------------|
| Product Model | JL-205C |
| Rated Voltage | 110-277VAC |
| Applicable Voltage Range | 105-305VAC |
| Rated Frequency | 50/60Hz |
| Rated Loading | 1000W Tungsten; 1800VA Ballast |
| Power Consumption | 0.5W [STD] / 0.9W [HP] |
| On/Off Level | 16Lx On 24Lx Off |
| Ambient Temp. | -40°C ~ +70°C |
| Related Humidity | 99% |
| Overall Size | 84(Dia.) x 66mm |
| Weight Approx. | 110g [STD] / 125g [HP] |

DIMENSIONS

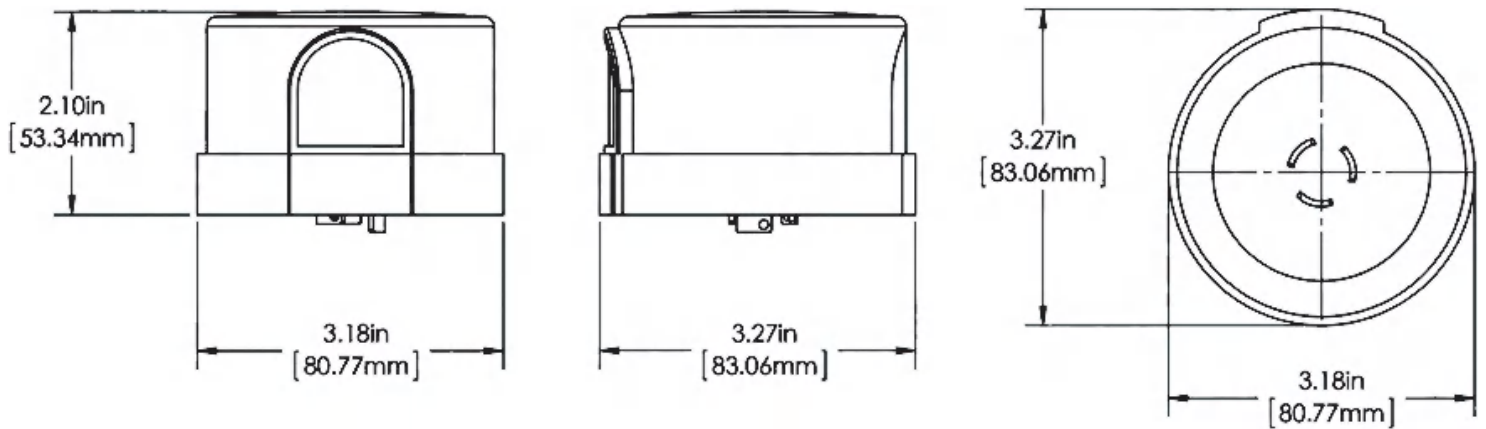

MS BI-LEVEL PIR SENSOR



ANT-5-4T



RC-100

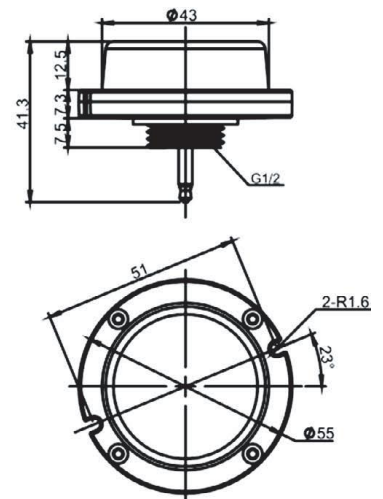

INTRODUCTION

The ANT-5-4T is a motion sensor that dims lighting from high to low based on movement. This slim, low-profile sensor is designed for installation inside the bottom of a light fixture body.

The sensors use microwave sensing technology that reacts to changes in movement within the coverage area. Once the sensor stops detecting movement and the time delay elapses lights will go from high to low mode and eventually to an OFF position if it is desired.

Sensors must directly “see” motion of a person or moving object to detect them, so careful consideration must be given to sensor luminaire placement and lens selection. Avoid placing the sensor where obstructions may block the sensor’s line of sight.

SPECIFICATIONS

| | |
|--------------------|---|
| Power supply | 12V-24V DC, >50mA |
| Dim control output | 0-10V, max. 25mA sinking current |
| HF System | 5.8GHz±75MHz |
| Transmission Power | <0.2mW |
| Detection radius | 20%/50%/75%/100% (1-8m) |
| Mounting height | Max 50 \times . (15m) |
| Time setting | 10s/1min/5min/10min/15min/20min/30min/60min |
| Light-control | 24H/10LUX/30LUX/50LUX |
| Temperature | -4°F — +140°F (-20°C — +60°C) |
| IP rating | IP65 |

DAYLIGHT SENSOR

Function

Open the daylight sensor by push II when remote control is in setting condition.



1 The light switches on at 100% when there is movement detected.

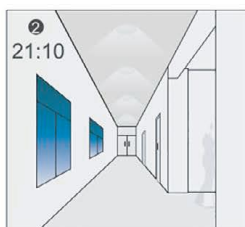

2 The light dims to stand-by level after the hold-time.

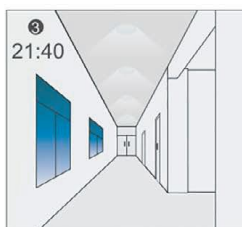

3 The light remains in dimming level at night.

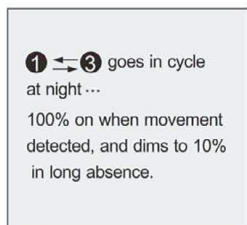

4 When the natural light level exceeds setpoint off to light, the light will turn off even if when the space is occupied.



5 The light automatically turns on at 10% when natural light is insufficient (no motion).

Settings on this demonstration:

Hold-time: 30min

Setpoint on: 50lux

Setpoint off: 300lux

Stand-by Dim: 10%

Stand-by period: +∞

(when the smart photocell sensor open, the stand-by time is only +∞)

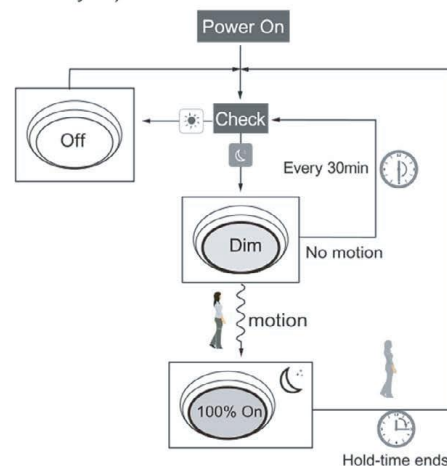

CORRIDOR

Function

This function inside the motion sensor to achieve tri-level control, for some areas which require a light change notice before switch-off. The sensor offers 3 levels of light: 100%/0-->dimmed light (natural light is insufficient) -->off; and 2 periods of selectable waiting time: motion hold-time and stand-by period; Selectable daylight threshold and freedom of detection area.

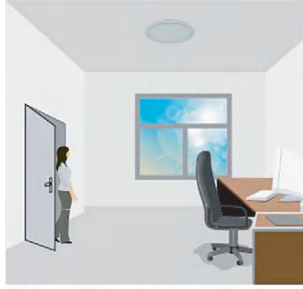

With sufficient natural light, the light does not switch on when presence is detected.

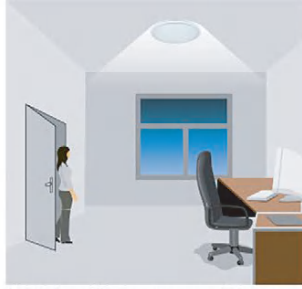

With insufficient natural light, the sensor switches on the light automatically when presence is detected.

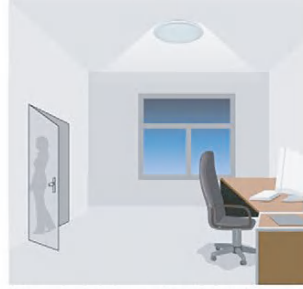

After hold-time, the light dims to stand-by level if the surrounding natural light is below the daylight threshold.



Light switches off automatically after the stand-by period elapses.

SENSOR

Coverage

